



Development and
production of
solutions that
prevent or reduce
the generation of
waste

knof

**SOCIAL
INNOVATIONS
„ON KEY“**



BUTIK STARA ŠOLA



SALON



ODGOVORNA SVEČKA



ZERO

knof



PREKRIVNA BARVA



EKOVITEK



BOLHA BOX

„you see waste
we see vision“

A wide-angle photograph of a massive landfill filled with discarded clothing and fabric. The waste is piled high, creating a sea of various colors and textures. In the background, a white car is parked on a dirt path that cuts through the waste. The sky is overcast, and the overall scene conveys a sense of environmental neglect and the scale of textile waste.

11 kg/person
EU textile waste
generation in a
year



STARA ŠOLA

BOUTIQUE

Knof solution: REPAIR / REUSE / RECYCLE



GATHER | SORT | PREPARE | SELL

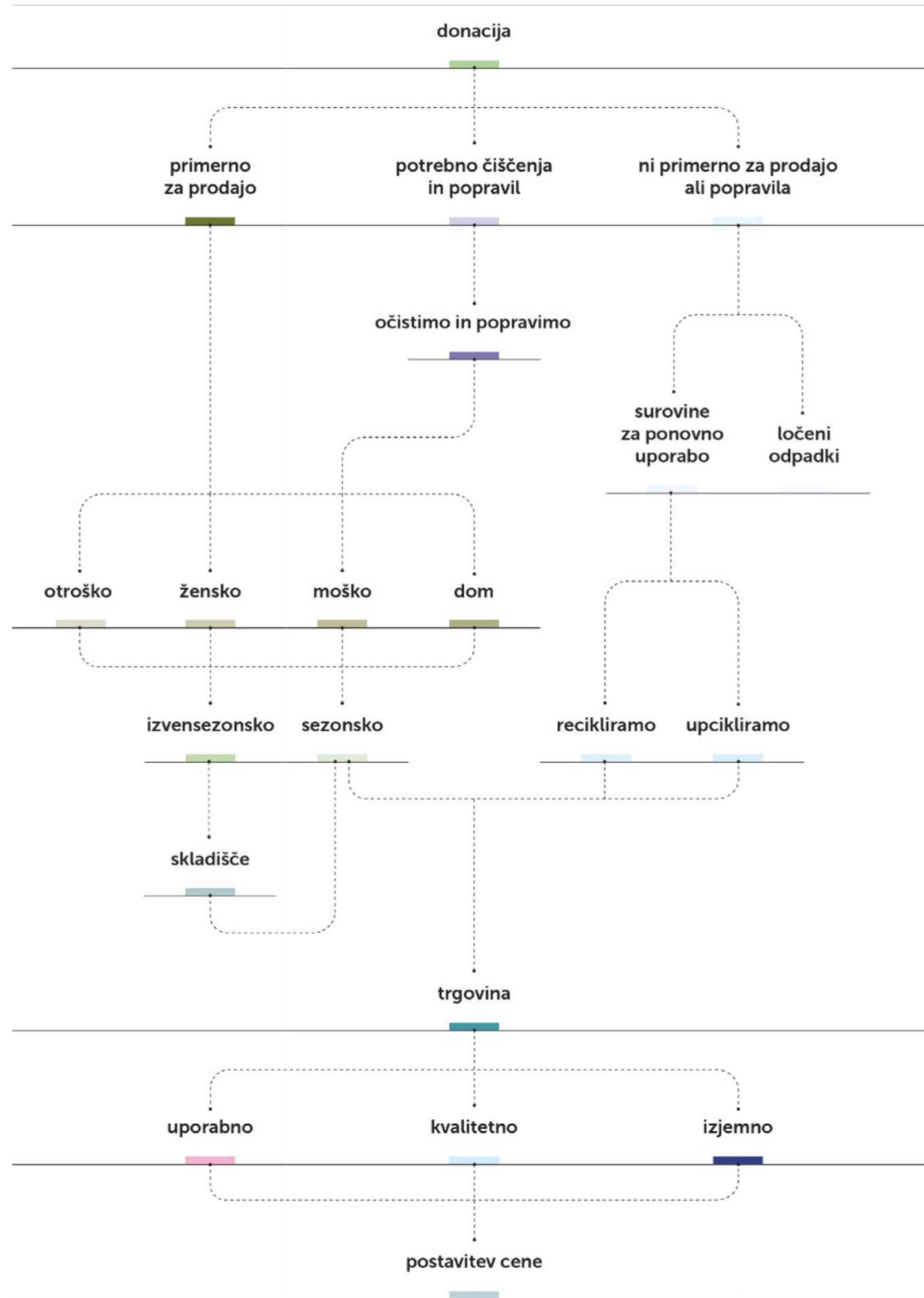

STARVA
10 LET
S



FAB

WE TRANSFORM WASTE FURNITURE FROM THIS INTO ...



82% lower CO₂
footprint





Kulturna dediščina



Originalen dizajn



*Inovativna pisarniška
oprema iz ponovne uporabe*



POBUDA:

„vsaj 1 miza ali omara v vsaki javni upravi naj bo iz ponovne uporabe“

Primer:

PREKO JAVNIH NAROČIL V SLOVENIJI LETNO NAROČIMO POHIŠTVA V VREDNOSTI 15 MILIJONOV EUR

če bi le 7% pohištva naročili iz ponovne uporabe bi to pomenilo prihranek 1.050 kosov pohištva iz odlagališč in sežigalnic in 12.000 kg prihranka CO₂ na leto, nova zelena delovna mesta v lokalnem okolju.

*Slovenija iz „non-combustion“ virov ustvari na leto 854.821 ton CO₂

SALON KNOF KRŠKO

NAJVEČJI SALON RABLJENEGA POHIŠTVA V SLOVENIJI



1500 M²
PRODAJNEGA
PROSTORA

SKLADIŠČE
PISARNIŠKE
OPREME

ODVOZ POHIŠTVA
OD STRANK

OBNOVA PO
NAROČILU



Rešujemo oblikovalsko dediščino pred ognjem in podaljšujemo življenjsko dobo predmetom.

Priljubljene blagovne znamke

STOL KAMNIK

ZAJEČAR

MURA

LIP RADOMLJE

MEBLO

LEVI'S

Najbolj iskano





LES
IVERAL

TRANSFORMATION OF WASTE PARTICLE BOARDS...



Knof *collection*

**VSEBUJE 97% MATERIALOV IZ
PONOVNE UPORABE**

Z uporabo rabljenih ivernih plošč za izdelavo modularnih sten za naš razstavni prostor smo okolju prihranili 800 kg materiala, zmanjšali ogljični odtis za 373 kg CO₂.

Naša sejemska stena pa hrani 1.221,60 kg CO₂.



WE TRANSFORM WASTE PLASTIC ITEMS FROM THIS INTO .

THE GROWING IMPORTANCE OF PROXIMITY ECONOMY

**IF WE REMOVE WASTE PLASTIC MORE
THAN 50 KM FROM THE SOURCE OF
ITS PRODUCTION, ITS RECYCLING IS
NO LONGER PAYABLE
ENVIRONMENTALLY AND
ECONOMICLY.**

Dr. Petar Varbanov, Brno University of
Technology



reinventing materials

local sourcing of recycled semi-products for use in furniture and construction industries

**tackling waste challenge with
producing of recycled products with
high added value**

mechanical recycling | focus on
industry waste | local green new
jobs

knof

Vzorci reciklirane plastike vir: KNOF



Zavod KNOF

2. registered social company in Slovenia

private institution

15 years of operation

15 employees (40% of persons with disabilities)

5 Stara šola reuse boutiques in Krško, Sevnica, Brežice, Novo Mesto and Litija



Krožni laboratorij circular lab

knof

OKOLJU PRIJAZNA
POSLOVNA SKUPNOST

CIRCULAR LAB

tloris

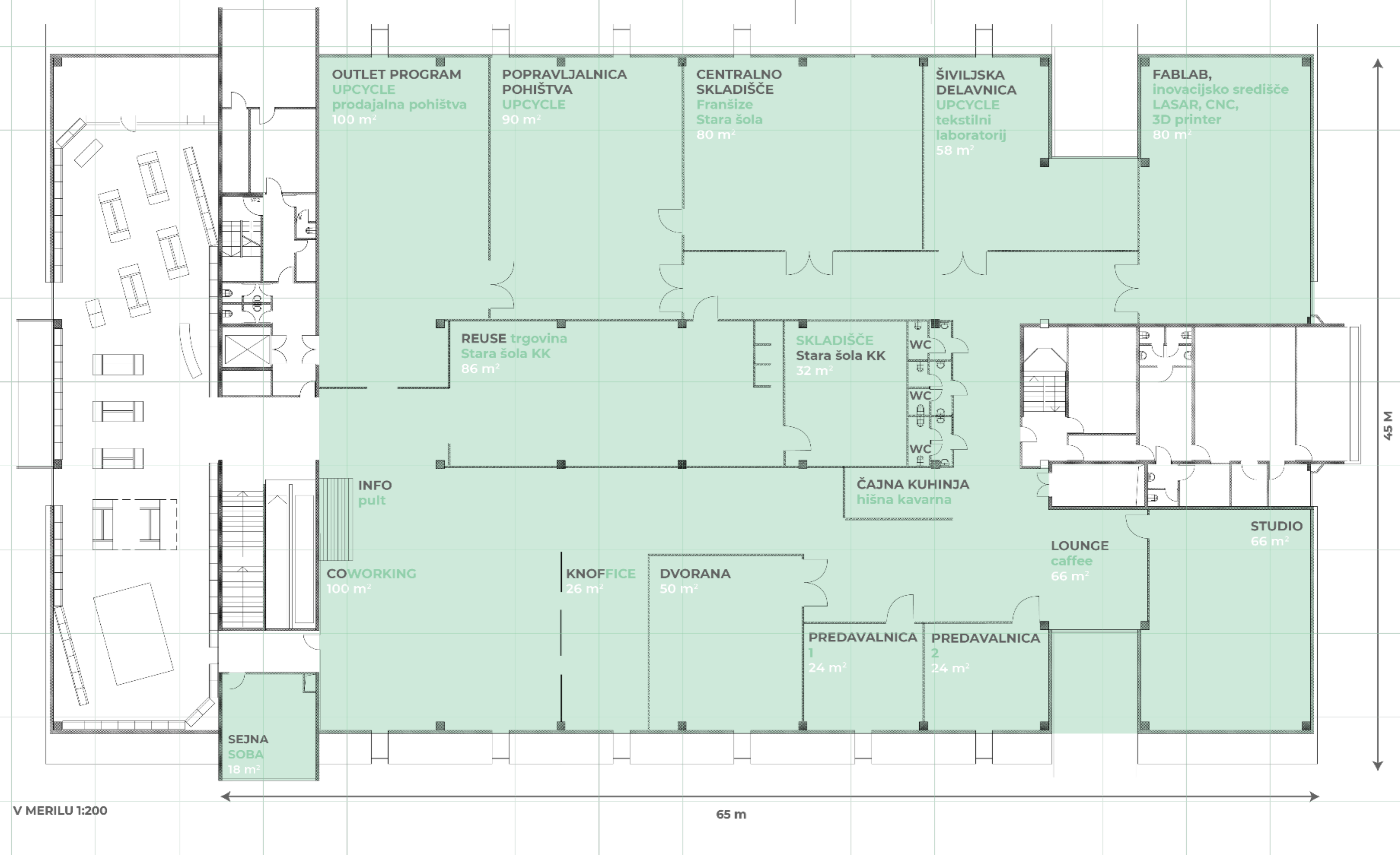

development projects

We work with research institutions,
municipalities, waste companies,
architects and other businesses

Lean innovation

Reuse | green public
procurements | closing of
material loops | eco design

knof

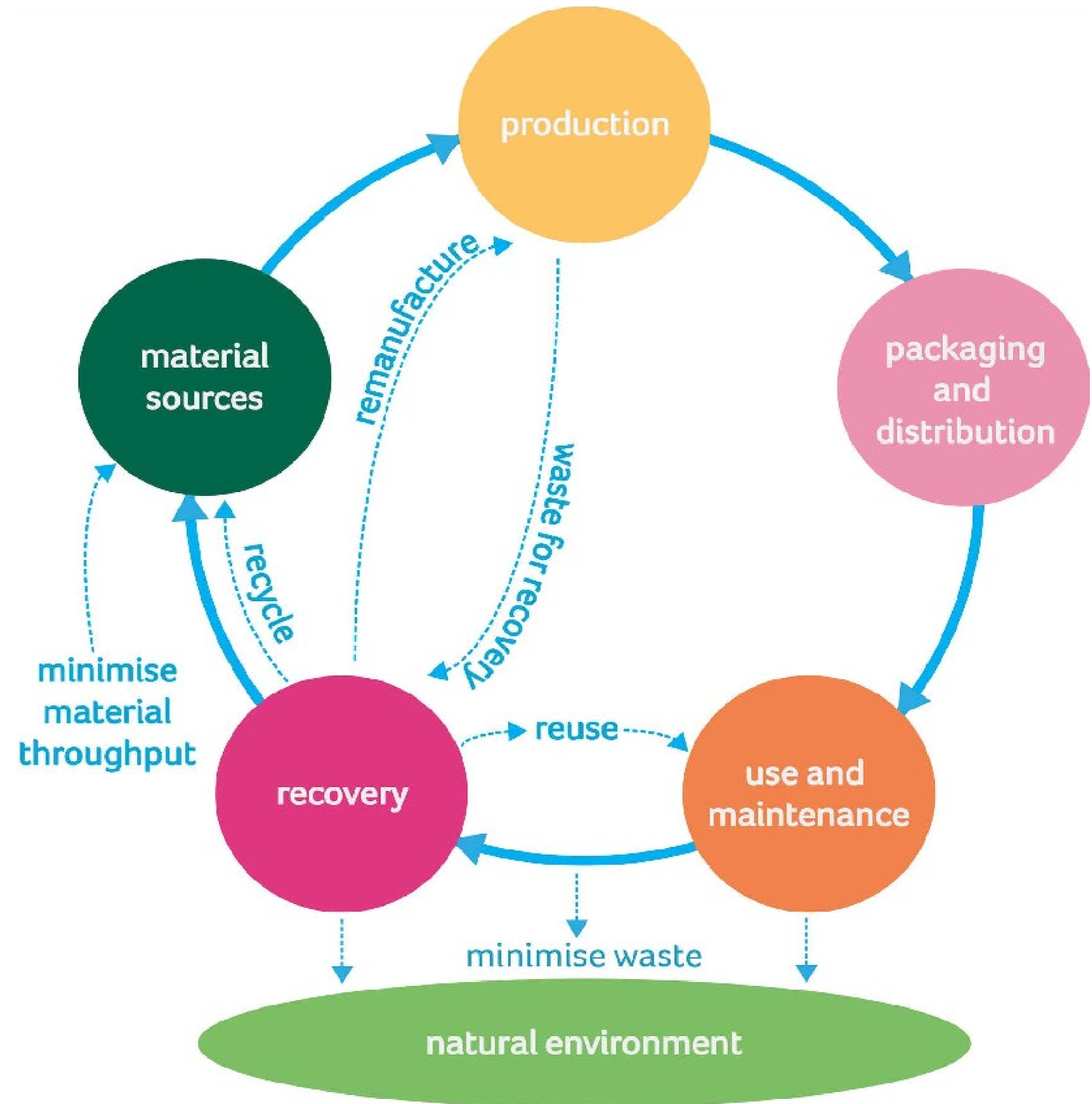



Stol iz reciklirane odpadne plastike

circular solutions in practice

Pilot testing and small production of innovative products in the field of waste textiles, furniture and also plastics.

5-stopenjska lestvica ravnanja z odpadki



Hands on circular

Fablab / wood workshop / sewing workshop / machines for plastic recycling

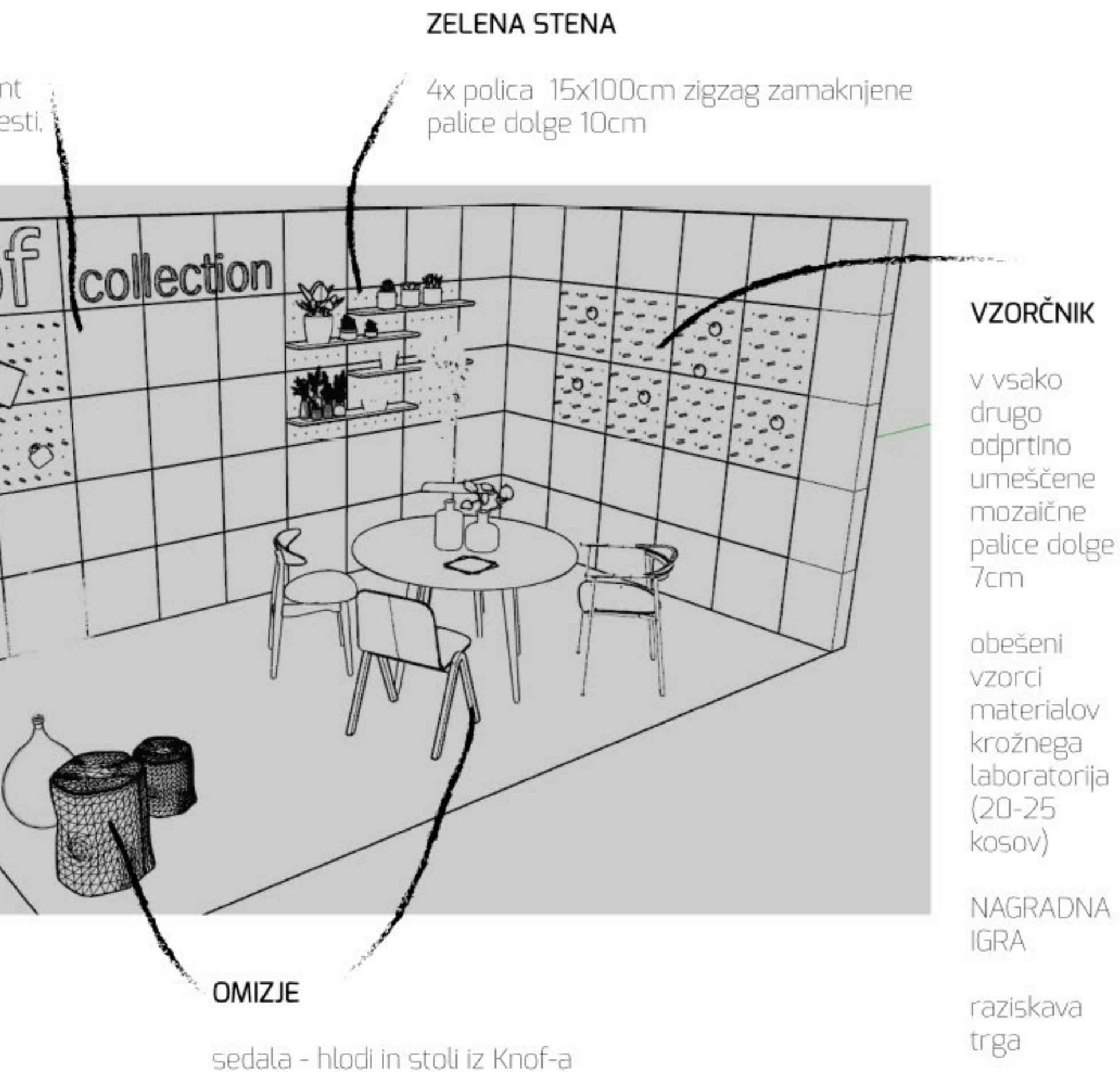

Idejna zasnova modularne stene KNOF vir: KNOF

design is everything

Old/upcycled/refurbished/recycled/responsible/zero waste
should be sexy. We achieve this through thoughtful and
professional design.

Circular needs to be cool.

Circular design management, cooperation
with industrial designers.

boutique technologies

With smaller production and an emphasis on research and development, we quickly adapt the entire production process to the client and develop "custom-made" solutions, from the restoration of existing furniture to the processing of "domestic waste materials" into new



We can only be limited by our imagination.

3D printer, laser machine, CNC lathe, sewing machines, grinding machines, processing of waste plastic and waste wood.

values of inclusion

As a social enterprise, we also include various vulnerable target groups in our training and recruitment activities.

In addition to the environmental, there is also a positive social impact.

We employ and train disabled people, Roma people, long-term unemployed people.

knof



Zelena delovna mesta vir: KNOF

2019: There is no planet B.
2022: Welcome to planet B.

Mojca Žganec Metelko
Director
mojca.metelko@knof.si



knof.si

